

## MK173-2X6-2S6P-L145W45-12V-20264

### LED Street and Outdoor lighting modules with optics

These LED modules are suitable for standard compliant street lighting, paths and squares in accordance with EN 13201. These modules are designed for built-in into luminaire casings. They enable a modular luminaire design. The modules dimensions aligned with Zhaga book 19, Compatible with third party optics, e.g. from DARKOO.



### Technical data

- Dimensions: 145x45 mm
- On-board push-in terminals (WAGO 2060)
- Allowed operating temperature at tc point: -30 to 85 °C (> 4200 mA)
- Use of external LED constant-current drivers
- Efficiency up to 180 lm/W
- Colour rendering index Ra: > 70
- Colour accuracy initially: 5 SDCM; after 50,000 hrs. operating time: 7 SDCM
- Lumen maintenance L80/B10: 50,000 hrs. (If 4200 mA)



### Specific technical data

Type	Typ. luminous flux at tp = 25 °C	Typ. luminous flux at tp = 65 °C	Typ. Colour temperature (CCT)	Colour rendering index CRI	Min. forward voltage at tp = 65 °C	Max. forward voltage at tp = 25 °C	Typ. forward current	Typ. power consumption at tp = 65 °C	Max. forward current	Efficacy of the module at tp = 25 °C	Efficacy of the module at tp = 65 °C
------	----------------------------------	----------------------------------	-------------------------------	----------------------------	------------------------------------	------------------------------------	----------------------	--------------------------------------	----------------------	--------------------------------------	--------------------------------------

### Outdoor-Z LED-module – L72.2 W49.5 H8

DK173-20264	2,420Lm	2,343Lm	5,000K	>70	11.2V	12.4V	1020	11.4W	4800	220Lm/W	213Lm/W
	3,408Lm	3,296Lm					1500	16.6W		213Lm/W	206Lm/W
	4,715Lm	4,554Lm					2100	23.6W		205Lm/W	198Lm/W
	6,912Lm	6,660Lm					3050	36.5W		192Lm/W	185Lm/W
	9,016Lm	8,673Lm					4000	49.8W		184Lm/W	177Lm/W
	9,180Lm	8,823Lm					4200	51.2W		180Lm/W	173Lm/W

\* The values mentioned above represent only statistical variables on account of the complex manufacturing process of light emitting diodes. The values do not necessarily correspond exactly to the actual parameters of every single product which can vary from the typical specification.  
 \*\* Production tolerance of voltage and power consumption: +10%/-4%; Measuring tolerance of luminous flux: ±7%  
 \*\*\* Measuring tolerance of CRI: ±2 | CRI > 70 on request

### DIMENSIONS (All dimensions in mm)

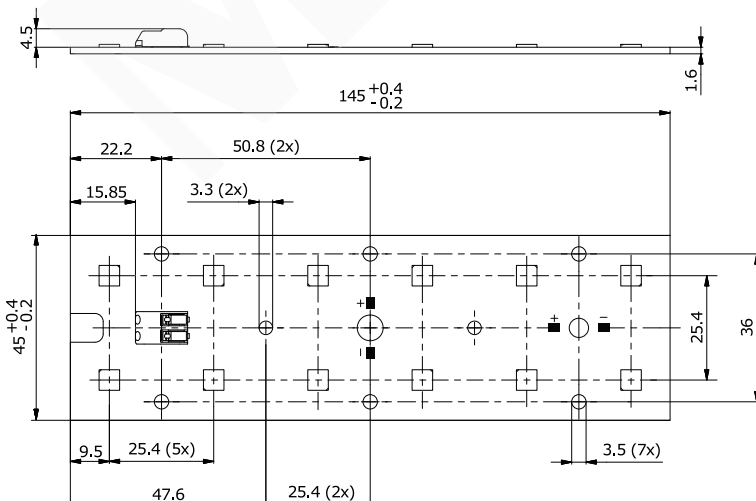

### Typical applications

- Installation in luminaires comerciais
- High bay lighting
- Flood and Area lighting
- Urban street lighting
- Road lighting

### Website

<http://www.led-module.cn/pro176>

